

AVOVA

Sperling-Fix i-Size USER MANUAL

76cm-150cm

15 months-12 years

≤18 kg

UNECE regulation no. R129



GB

Made in Germany

5103033 18/10

1 PRODUCT OVERVIEW

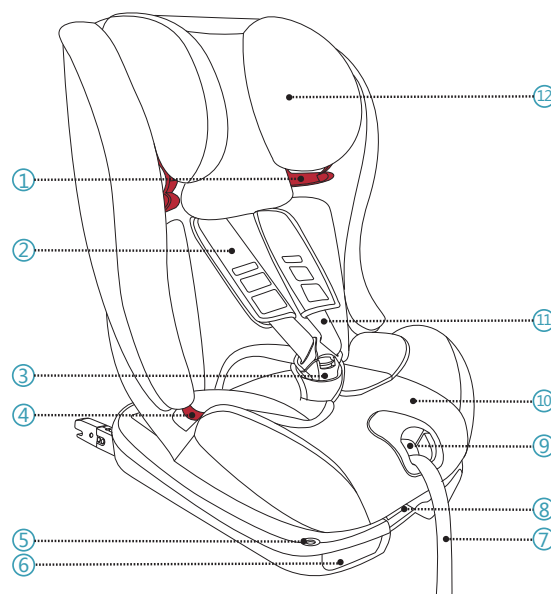

- | | |
|---------------------------|------------------------------|
| 1. Shoulder belt guide | 7. 5-point harness adjuster |
| 2. Chest pad | 8. Recline adjustment handle |
| 3. 5-point harness buckle | 9. Harness adjustment button |
| 4. Lap belt guide | 10. Seat cushion |
| 5. ISOFIX indicator | 11. 5-point harness |
| 6. ISOFIX release lever | 12. Young child insert |

2 INTRODUCTION

Thank you for choosing AVOVA Sperling-Fix i-Size to ensure your child's safe journey. The seat has been designed, tested and certified according to the UNECE R129, the Enhanced Child Restraint Systems.

The seal of approval **E** (in a circle) and the approval number are located on the orange approval label (a sticker on the child seat). The child seat is designed for a child with statures of 76cm-150cm, approximately 15 months - 12 years old. When used for statures between 135cm and 150cm, Sperling-Fix i-Size might not fit in all vehicles due to a low position of the vehicle roof at the side of the chosen installation position.

It is important that you read this user manual BEFORE installing your child seat. Incorrect installation and/or misuse of the seat could endanger your child. This user manual should be kept to hand in the child seat's user manual compartment **15** at all times.

The following symbols are used in this user manual:

⚠ DANGER DANGER indicates a hazardous situation which, if not avoided, will result in death or serious injury.

⚠ WARNING WARNING indicates a hazardous situation which, if not avoided, could result in death or serious injury.

⚠ CAUTION CAUTION indicates a hazardous situation which, if not avoided, could result in minor or moderate injury.

GENERAL SAFETY INFORMATION

⚠ DANGER AVOVA Sperling-Fix i-Size is approved for statures of 76cm-150cm, in the forward-facing direction.

⚠ DANGER AVOVA Sperling-Fix i-Size can only be used in vehicles fitted with ISOFIX anchoring points **21** and a Top Tether anchoring point for children between 76cm and 100cm.

⚠ DANGER Only use the 5-point harness **11** to secure your child when he/she is less than 100cm in height. Once your child reaches 100cm and over, you must use the vehicle's 3-point belt.

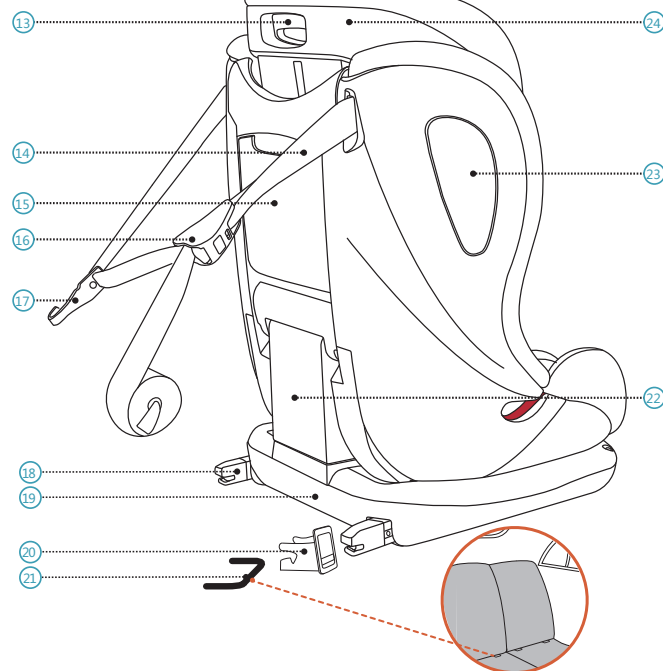

- | | |
|--------------------------------|--|
| 13. Headrest adjustment handle | 19. Seat base |
| 14. Top Tether | 20. ISOFIX insertion guide |
| 15. User manual compartment | 21. ISOFIX anchoring points (automobile) |
| 16. Top Tether adjuster | 22. Backrest |
| 17. Top Tether hook | 23. Integrated side impact protection |
| 18. ISOFIX connector | 24. Headrest |

⚠ DANGER When the child is taller than 150cm or the child's shoulders exceed the highest position of the shoulder belt guide **1**, the child must change to a seat which is suitable for taller children, or the vehicle seat.

⚠ DANGER The young child insert **12** contains a shock-absorbing foam and must be used until the child is 2 years old. From the age of 2 years onwards it is allowed to remove the young child insert. The cover of the headrest contains an additional shock-absorbing foam on both sides. This foam must be used until the child is 4 years old. From the age of 4 years onwards it is allowed to remove this foam from the headrest cover.

⚠ DANGER Sperling-Fix i-Size has been approved for statures between 100cm and 150cm without using the ISOFIX connector **18** and Top Tether **14** in vehicles. AVOVA strongly recommends the use of ISOFIX and Top Tether at all times where possible, for maximum safety.

⚠ DANGER Sperling-Fix i-Size is compatible with universal seating positions in vehicles. For suitable positions in your vehicle, please read your vehicle handbook.

⚠ DANGER Never leave your child unattended in the child seat.

⚠ DANGER Never secure your child or the child seat with a 2-point belt as that may cause serious injuries or death in the event of an accident.

⚠ WARNING The child seat must always be secured when it is in the vehicle, even if no child is being transported, by using ISOFIX anchoring points **21** and Top Tether anchoring point or vehicle 3-point belt.

⚠ WARNING The child seat needs to be checked regularly to ensure all the parts are functioning correctly and free from any damages.

⚠ DANGER Please dispose of your seat in the event of any vehicle and/or violent collision as the child seat may be damaged but the damage may not be immediately visible.

⚠ DANGER Do not use lubricants on or modify in any way your Sperling-Fix i-Size as this could seriously affect its ability to protect your child.

⚠ WARNING Please do not expose the child seat under intensive direct sunlight. Under intensive direct sunlight, the child seat or some of the child seat parts can get very hot which can cause harm to the child.

⚠ DANGER Use on the rear seat: Move the front seat forward far enough that the child's feet cannot reach the backrest of the front seat as that is safer.

⚠ WARNING The rigid items and plastic parts of a Sperling-Fix i-Size shall be so located and installed that they are not liable, during everyday use of the vehicle, to become trapped by a movable seat or in a door of the vehicle.

⚠ CAUTION The vehicle seats may show signs of wear and tear when using child seat. In order to avoid that, car seat protectors may be used.

⚠ DANGER Make sure all passengers are informed about how to release your child in the case of an emergency.

⚠ WARNING Make sure luggage or other objects are properly secured. Unsecured luggage may cause severe injuries to children and adults in case of accidents.

⚠ CAUTION Do not use any aggressive cleaning products, which may harm the construction material of the child seat.

⚠ DANGER AVOVA advises that child seats should not be bought or sold second-hand.

⚠ DANGER DO NOT use the child seat for longer than 12 years. Due to aging, the quality of the material may change.

⚠ WARNING DO NOT use at home. It's not designed for home use and can only be used in a vehicle.

⚠ DANGER If in doubt, consult either the child seat manufacturer or the retailer.

3 INSTALLATION

GETTING READY

Remove the vehicle seat headrest or move it to the highest position so that it will not interfere with the child seat headrest **24** in the highest position.

⚠ DANGER Please ensure the vehicle seat that has the child seat installed is in upright position if the vehicle seat is reclinable.

AVOVA Sperling-Fix i-Size can be installed forward-facing by latching the ISOFIX connectors **18** to the ISOFIX anchoring points **21** and attaching the Top Tether **14** to the vehicle Top Tether anchoring point. It is compatible with universal seating positions in vehicles. Please read your vehicle handbook.

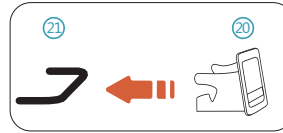

1. Fit the ISOFIX insertion guides **20** to the vehicle's ISOFIX anchoring points **21**.

⚠ CAUTION It is suggested to use ISOFIX insertion guides to help in the installation. They help to prevent damages to the vehicle seat. If the vehicle seat can be folded, remove the ISOFIX insertion guides before doing so.

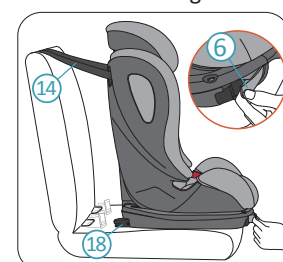

2. Position Sperling-Fix i-Size on the suitable vehicle seat, leaving enough space between the child seat and the vehicle seat backrest. Place the Top Tether **14** at the back of the vehicle seat. Pull one of the ISOFIX release levers **6** until a clear "click" is heard. Then release the lever back to its original position and pull the lever again until the ISOFIX connector **18** fully extends. Repeat the actions on the other ISOFIX release lever to fully extend the other ISOFIX connector.

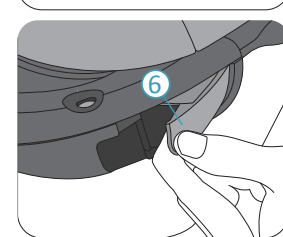

3. Adjust the child seat position and engage both of the child seat ISOFIX connectors **18** to the vehicle ISOFIX anchoring points **21** through the ISOFIX insertion guides **20**.

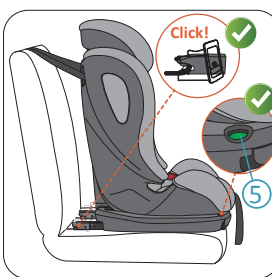

⚠ DANGER Audible "clicks" should be heard when the ISOFIX connectors engage the vehicle ISOFIX anchoring points successfully. Check and ensure the green signs are visible on both ISOFIX indicators **5**.



4. Push the child seat firmly towards the vehicle seat backrest as far back as possible until it rests against the vehicle seat backrest.

⚠ DANGER Please check that the child seat is connected securely by trying to pull it out from both sides.



5. Hold down the button on Top Tether adjuster **16**. Pull the tether on the hook end to obtain the desired Top Tether length.

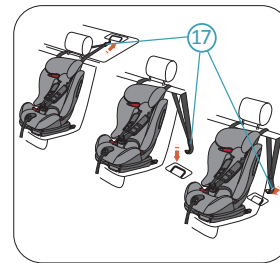

6. Connect the Top Tether hook **17** onto the vehicle's Top Tether anchoring point. Your vehicle's Top Tether anchoring point is located in one of the positions shown in the picture on the left. If in doubt please read your vehicle handbook.

⚠ DANGER Top Tether point always has the sign as below:

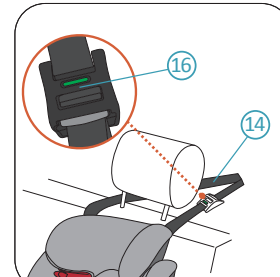

7. Pull the loose end of the Top Tether **14** to tension it.

⚠ DANGER The green indicator should be visible on the Top Tether adjuster **16** when the Top Tether is correctly tensioned.

⚠ DANGER Make sure the child seat backrest **22** is touching the vehicle seat backrest and the vehicle seat headrest is not pushing the child seat away from the vehicle seat backrest. You may adjust or even remove the vehicle seat headrest if needed.

⚠ DANGER Ensure both ISOFIX indicators **5** and Top Tether adjuster **16** are showing green signs after installation.

4 ADJUSTING THE RECLINE



AVOVA Sperling-Fix i-Size has 3 recline positions. In some vehicles, it may be necessary to loosen the Top Tether **14** before adjusting the recline position and please remember to re-tension the Top Tether after adjusting the recline position. To adjust the recline position, hold the recline adjustment handle **8** up and slide the seat cushion by pushing and pulling it back and forth against the seat base to reach the desired recline position. Then release the recline adjustment handle to ensure the recline position is positively engaged.

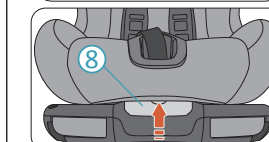

⚠ DANGER Always loosen the Top Tether **14** by pressing and holding down the Top Tether adjuster **16** button and pulling the Top Tether from the hook end. After the recline is adjusted to the desired position, tighten up the Top Tether by pulling the Top Tether from the loose end.

5 POSITIONING THE CHILD

ADJUST HEADREST BEFORE SECURING YOUR CHILD.

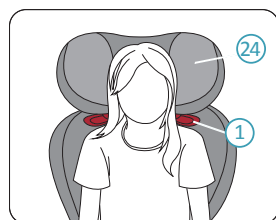

1. Seat your child in the child seat.
2. The headrest (24) shall be adjusted to a level that the shoulder belt guide (1) is just above the child's shoulders.

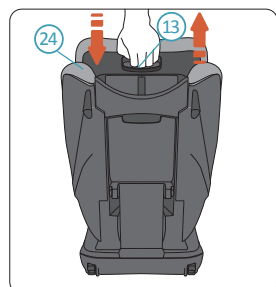

3. Operate and hold headrest adjustment handle (13) on the back of the headrest, which unlocks the headrest.
4. While holding the headrest adjustment handle (13), move the unlocked headrest (24) to the desired height. Release the handle to lock the headrest.

⚠ DANGER The child seat headrest will need to be adjusted from time to time as the child grows. Child's shoulders should be just under the shoulder belt guide (1).

⚠ DANGER There are 9 positions in total for the headrest (24). You may use the 4 lowest positions in the 5-point harness (11) mode. If the headrest is in its highest position with 5-point harness and you can no longer accommodate your child's shoulders, it means you should use your vehicle's 3-point belt instead. Remove the 5-point harness according to the instructions in Section 7. Then the headrest can be moved into 5 additional higher positions.

A. SECURING YOUR CHILD WITH 5-POINT HARNESS.

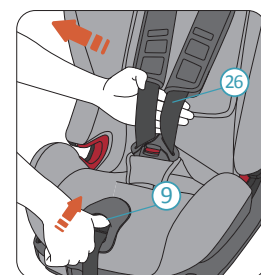

1. Hold down the harness adjuster button (9) and pull shoulder harness (26) towards you as much as possible. Make sure you pull the shoulder harness from beneath the chest pads as shown.

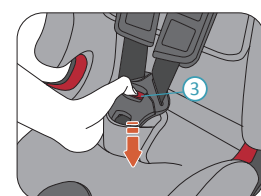

2. Press the red button on the 5-point harness buckle (3) to unbuckle it.



3. Seat your child in Sperling-Fix i-Size. Route the shoulder harness (26) over your child's shoulders and engage the buckle tongues (25) together. Click the engaged tongues into the buckle body.

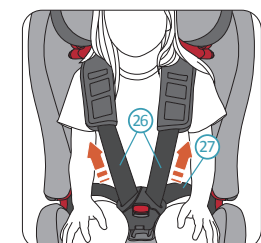

4. Pull both shoulder harness (26) to tighten the lap harness (27).

⚠ DANGER Please check that the lap strap is worn low down so that the child's pelvis is firmly engaged.

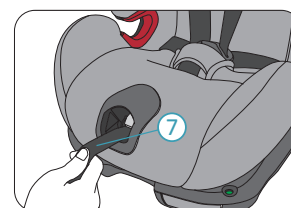

5. Pull the 5-point harness adjuster (7) until the harness firmly secures your child.
- ⚠ DANGER** Please check after tightening that none of the harness straps are twisted.
6. Finally pull both chest pads down fully.

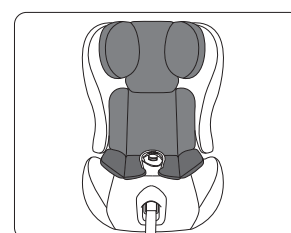

For optimum protection of your child, Sperling-Fix i-Size has been developed with a unique young child insert (12) which includes one layer of high-performance foam within the head area on both left and right sides.

For a younger child (< 2 years) using the Sperling-Fix i-Size he/she must use the young child insert. The insert is pre-fitted to your child seat and is also available as spare parts from AVOVA retailers. From the age of 2 years onwards it is allowed to remove the young child insert. The cover of the headrest contains an additional shock-absorbing foam on both sides. This foam must be used until the child is 4 years old. From the age of 4 years onwards it is allowed to remove this foam from the headrest cover.

B. SECURING YOUR CHILD WITH 3-POINT VEHICLE BELT.

⚠ CAUTION Make sure that the shoulder belts of the harness are removed and other parts of the harness are properly stored, according to the instructions in Section 7.

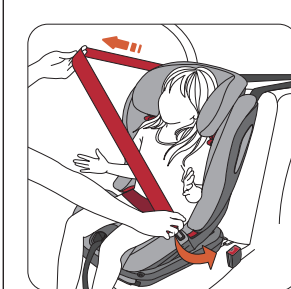

1. Position the vehicle's 3-point belt in front of the child and lock the belt into the buckle of the vehicle with a click. Make sure that the 3-point belt is not twisted.

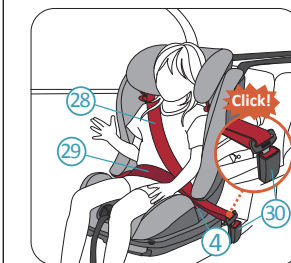

2. Place the shoulder belt section (28) and lap belt section (29) on the side of the vehicle seatbelt buckle (30) into the red color lap belt guide (4) of the seat cushion.

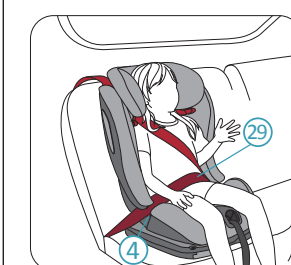

3. Place the lap belt section (29) on the other side of the seat cushion into the red lap belt guide (4).
- ⚠ DANGER** The lap belt section (29) must lie as low as possible over the child's pelvis on both sides to provide the best protection.

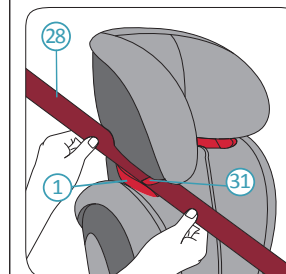

⚠ WARNING If the shoulder belt guide (1) is concealed by the backrest (22), adjust the headrest (24) upwards to allow the shoulder belt section (28) can be inserted easily into the shoulder belt guide and then adjust the headrest back to the correct height.



⚠ DANGER Check that the shoulder belt (28) runs over your child's collar-bone, not across his/her neck.



5. First pull the shoulder belt part that crosses the body of the child to remove the slack from lap section. Then pull the shoulder belt (28) part above the child seat to remove the remaining slack.

⚠ DANGER AFTER SECURING YOUR CHILD, PLEASE CHECK BELOW BEFORE YOUR TRAVEL:

1. The child seat is correctly secured. The lap belt (29) runs in the lap belt guide (4) on both sides of the seat cushion (10).
2. The shoulder belt (28) runs in the lap belt guide (4) on the side of vehicle's 3-point belt buckle (30) and the shoulder belt guide (1) on the other side of the headrest (24).
3. The vehicle's 3-point belt is tight and not twisted. The 3-point belt buckle (30) must not be positioned in the lap belt guide (4).

6 REMOVAL

1. Detach the Top Tether from your vehicle.
2. Pull the ISOFIX release levers on both sides to release the ISOFIX connectors. You can now remove the child seat.

7 REMOVAL AND REFITTING THE 5-POINT HARNESS

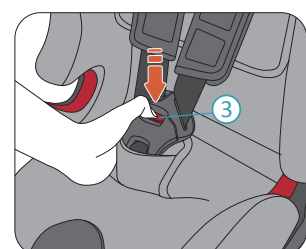

1. Uninstall the child seat from your vehicle. See instructions in Section 6.
2. Press the red button on the harness buckle (3) and open the harness.
3. Adjust the headrest to the highest position where the chest pad linkage stops the headrest from going further up.

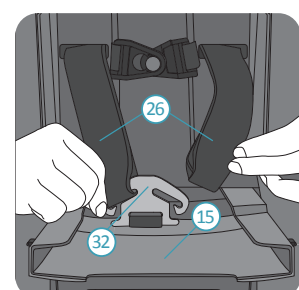

4. Open the user manual compartment (15) at the back of the child seat. Hold the connecting piece (32) and remove the shoulder harness (26) from it carefully. It may give you some convenience if you loosen the 5-point harness adjuster a bit. Please don't drop the connecting piece and place it in the pre-allocated space and then tighten up the 5-point harness adjuster.

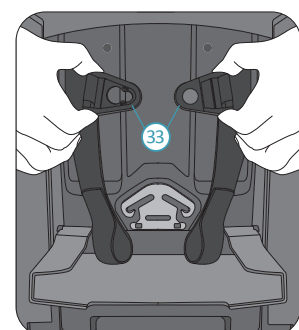

5. Unlock and separate the chest pad buckle (33).

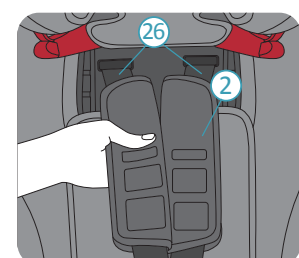

6. From the front of the seat, pull the shoulder harness (26) and the chest pad (2) linkage together out from the child seat backrest slots.

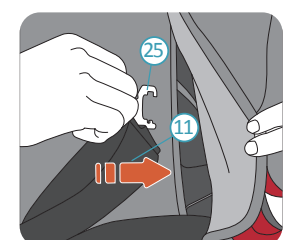

7. Put the buckle tongue (25) into the slot behind cover, then hide the shoulder harness and shoulder pad behind the cover.

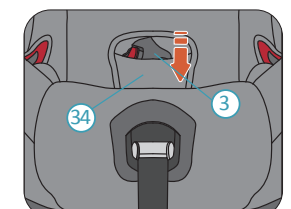

8. Remove the 5-point harness buckle (3) body from the crotch pad (34).

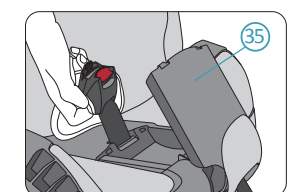

9. Open and hold the buckle storage cover (35) under the seat cover. Push the buckle through the slot in cover and put it in the buckle storage. Then close the storage cover.

10. Place the crotch pad below the seat cover. Now the harness is removed. You can restore the seat cover.

REFITTING THE 5-POINT HARNESS.

Refit the harness in reverse order. If you have any question, please contact AVOVA for help.

8 CARE AND MAINTENANCE

CARE AND MAINTENANCE

You may want to remove and wash the cover from time to time. Please do so with mild detergent in the delicates programme of the washing machine (30°C). Please refer to the washing label of the cover. The plastic parts can be cleaned with a mild soap and water.

⚠ DANGER The child seat must not be used without the AVOVA seat cover or young child insert if required for the child's age (< 2 years). The cover is a safety feature and may only be replaced by an original AVOVA cover.

REMOVING AND REFITTING THE COVER

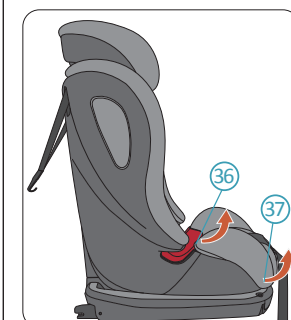

1. Move the headrest to the highest position. Release the cover hooks (36) at the lap belt guides and the elastic bands (37) at the front of the seat on both sides. Then remove the seat cover.

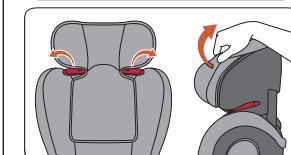

2. Pull out the trim of the headrest cover from the plastic part. Then release the loops behind the headrest cover.

Please refit the cover in the reverse order.

9 WARRANTY

1. The warranty for AVOVA Sperling-Fix i-Size lasts for 2 years from the date of original purchase from new. The usage of the product should be in accordance with this user manual. Any damage caused by operations against the instructions in this user manual will void the warranty.

2. Please keep your proof of purchase properly in case of a warranty claim.

3. Never use third parties for maintenance, repair or modification otherwise you will void the warranty. Always check with AVOVA retailers for advice.

If you have any further questions regarding the child seat's use, please feel free to contact us:

AVOVA GmbH
Blaubeurer Straße 71
89077 Ulm
Germany

T: +49 731 379941-0
info@avova-childcare.com
www.avova-childcare.com

10 DISPOSAL

When you need to dispose of the child seat, please refer to your local waste disposal regulations. If you have further questions, please contact your communal waste management or administration of your city.